

VILLE D'OTTIGNIES L-L-N

2° Division (CEROUX-MOUSTY)

Section A

Echelle: 1/250

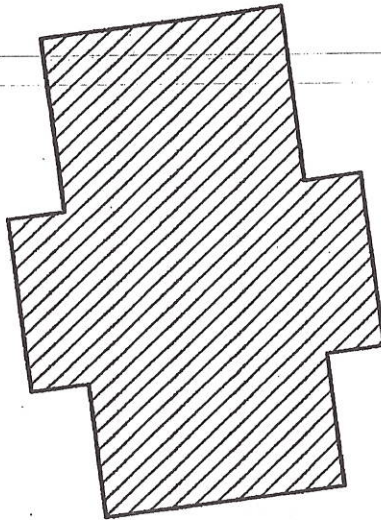
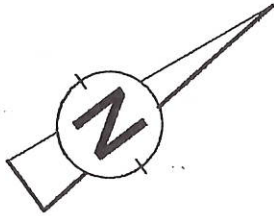

BRUYERE-MASSON

Limite à l'angle mur

x: 473.143
y: 142.727

Borne nouvelle

x: 503.570
y: 146.820

Superficie: 6a 06ca

LOT 1

Zone capable de bâtisse

Front de bâtisse

Borne à placer

235 200

-15

Borne nouvelle

506.3
175.2

50

10.02m

Borne an

Superf: 40

47/8

LOT

one capable

11.30

505.682
y: 122.331

-14

Borne à placer

Aligneme